

OPEN SPACE / MIXED USE EMPLOYMENT LAND FOR SALE

CHATHAM-KENT

ST. CLAIR ST. E & PIONEER LINE



HIGHLIGHTS

- The subject property is located adjacent to an existing retail centre anchored by a Walmart Supercentre and a Real Canadian Superstore.

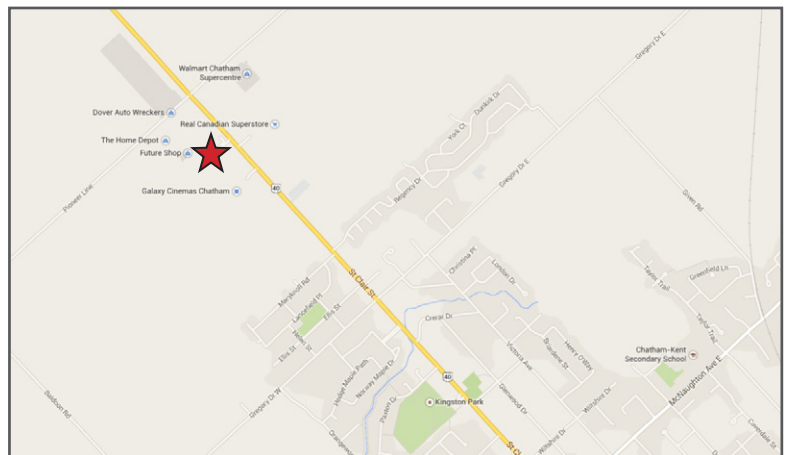

For more information, please contact:

Allan Scully
905 326 6400 x 7616
ascully@smartcentres.com

700 APPLEWOOD CRES.
VAUGHAN, ON. L4K 5X3
WWW.SMARTCENTRES.COM

OPEN SPACE / MIXED USE EMPLOYMENT LAND FOR SALE

CHATHAM-KENT

ST. CLAIR ST. E & PIONEER LINE

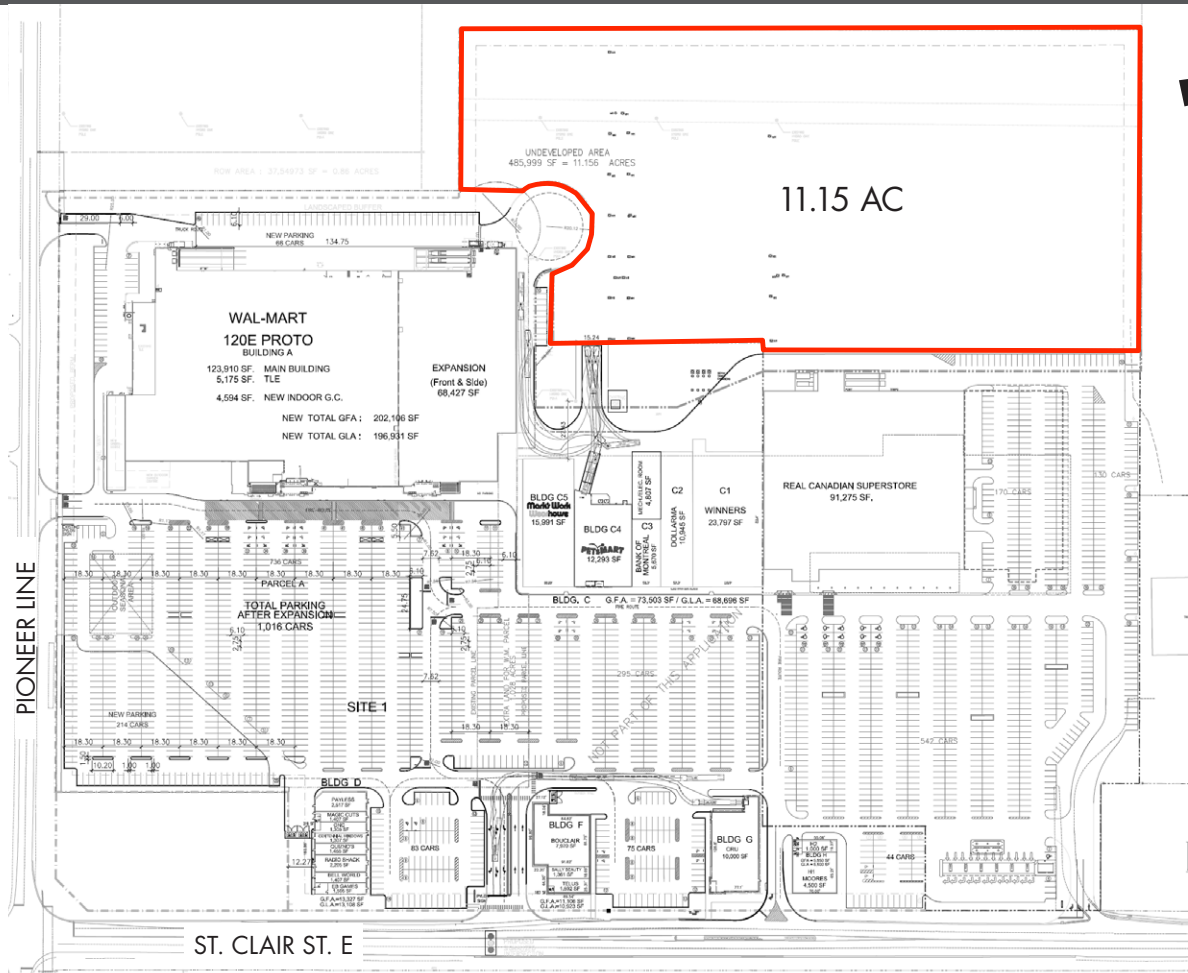

ADDITIONAL INFORMATION

MUNICIPAL ADDRESS

801 St. Clair Street E., Chatham, ON.

ZONING

Open Space Zone

OFFICIAL PLAN DESIGNATION

Open Space/Conservation Lands

SITE DESCRIPTION

The subject property is vacant and is mostly covered with short growth vegetation with the exception of a forested area in the north east corner.

For more information, please contact:

Allan Scully
905 326 6400 x 7616
ascully@smartcentres.com

700 APPLEWOOD CRES.
VAUGHAN, ON. L4K 5X3
WWW.SMARTCENTRES.COM